

SITE PLAN

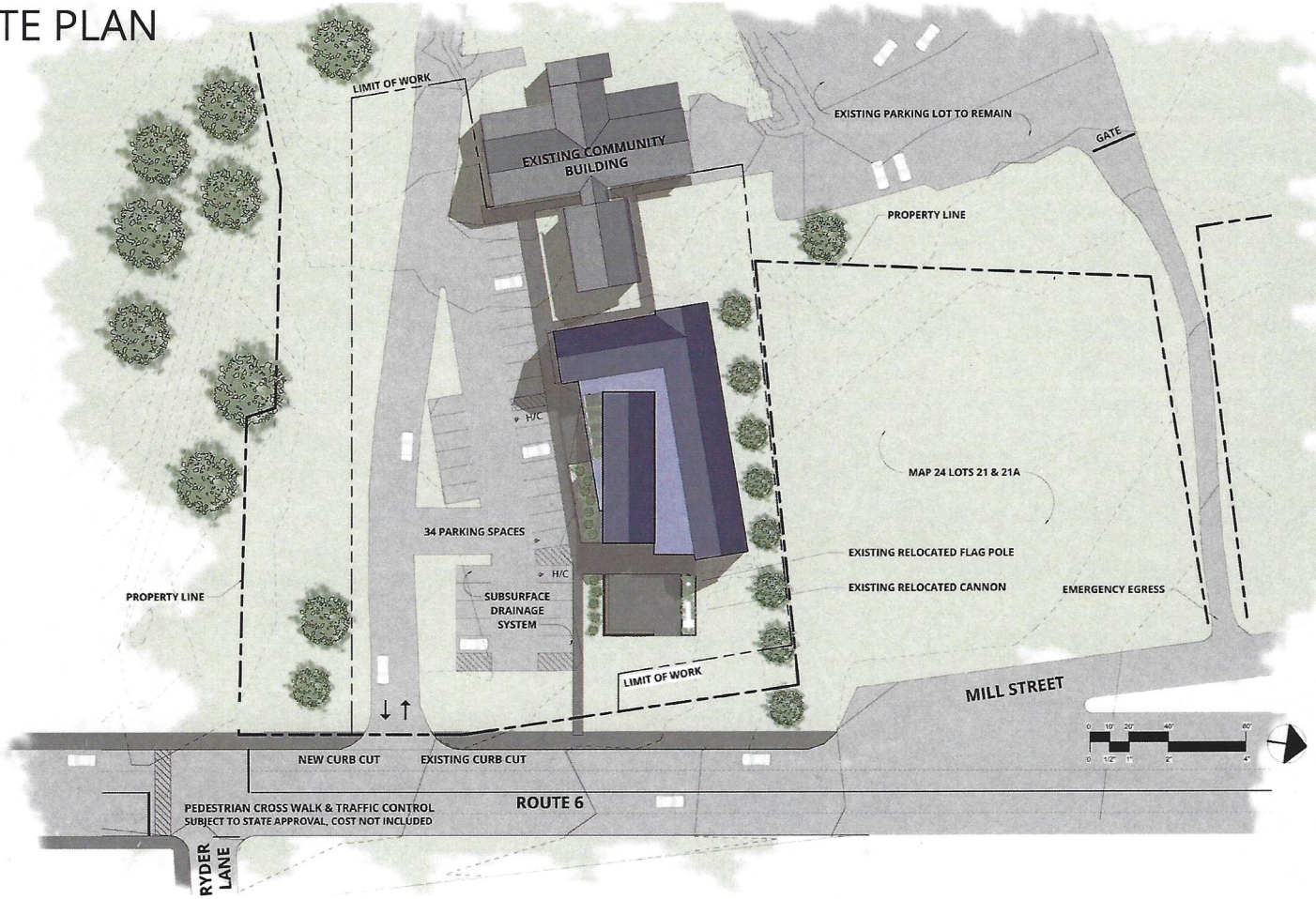

FLOOR PLAN 8,500 GSF

- Board of Selectman's Secretary - 128 SF
- Town Administrator - 210 SF
- Town Admin. Conference room - 152 SF; 8 Person
- Finance Director- 177 SF
- Finance Conference Room - 149 SF; 8 Person
- Payroll - 106 SF
- IT Room - 98 SF
- Health Department- 260 SF
- Nurse - 240 SF
- Treasurer's Office - 190 SF
- Collector's Clerk & Harbormaster's Clerk - 401 SF
- Vault - 122 SF
- Open Area 1- 1,072 SF
Town Clerk, Assessor's Department, Building Department
- Open Area 2 - 464 SF
Registrar & Accounts Payable
- Large meeting room - 454 SF; 30 Seated plus Selectmen
- Breakout Space 1 - 83 SF; 4 People
- Breakout Space 2 - 83 SF; 4 People
- Staff Lounge - 167 SF
- Staff Workroom - 222 SF

- Health Department Storage - 76 SF
- Finance Storage - 110 SF
- Assessor's Storage - 63 SF
- Planning & Building Storage - 150 SF
- Audio/visual Storage - 25 SF
- Meeting room Storage - 60 SF
- Mechanical & Electrical Room - 91 SF
- Sprinkler Room - 43 SF

